

MODELS RTU-1000 ERM-1000 & ERV-3615

IPB058

072007

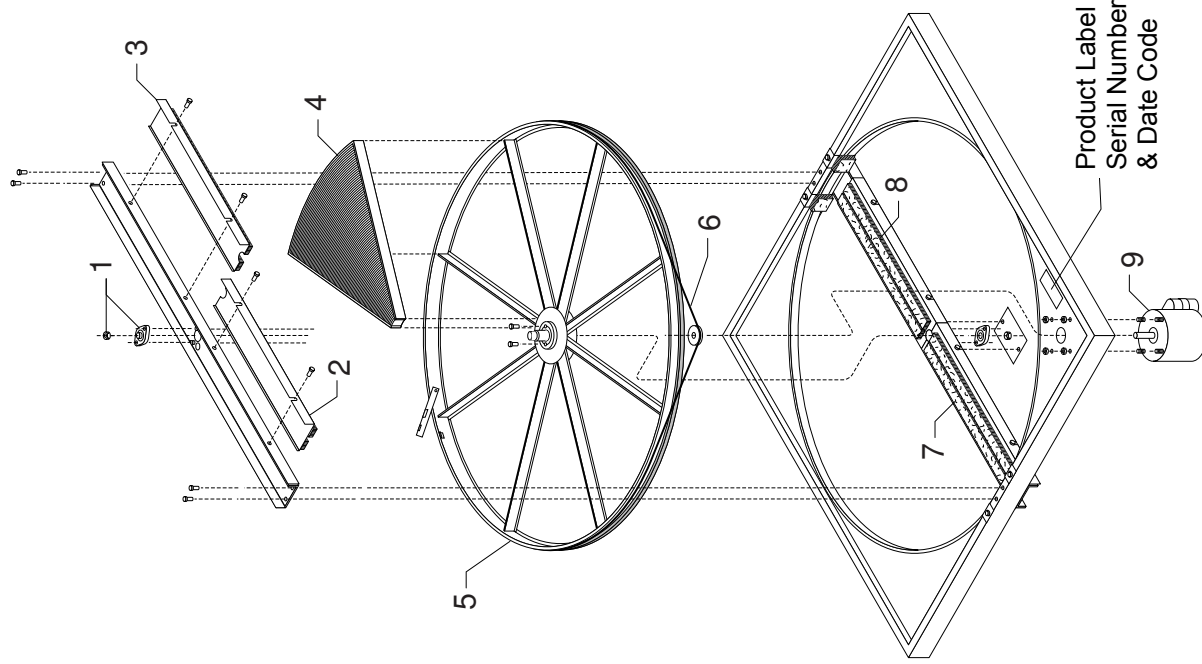

ITEM	DESCRIPTION	AIRXCHANGE PART NO.
1	Bearing Kit	181715
2	Diameter Seal, Pulley Side	181630B
3	Diameter Seal, Pulley Side	181629B
4	Segment, Desiccant (up to Date Code 9710)	181647A
4	Segment, Desiccant (Date Code 9711 and up)	181659A
4	Segment, Sensible (up to Date Code 9710)	181645A
4	Segment, Sensible ((Date Code 9711 and up)	181657A
5	Stainless Steel Wheel Assy.	183631B
6	Drive Belt Set	181609
7	Diameter Seal, Motor Side	181627B
8	Diameter Seal, Motor Side	181628B
9	Motor/Belt/pulley kit 230V 1/20HP 1PH	18360039
9	Belt/pulley kit for 115V Wheel Motor listed below	18360025

NOTE: ALL OTHER INTERNAL COMPONENTS INCLUDING THOSE ITEMS BELOW ARE AVAILABLE FROM LOCAL HVAC OR ELECTRICAL SUPPLY WHOLESALERS

COMMON REPLACEMENT ITEMS	RTU-1000	ERV-3615
Intake Hood Metal Mesh Filter	(2) 16 x 20 x 1	(2) 15 x 20 x 2
Outdoor Air Filter 2" Pleated	NA	(2) 16 x 20 x 2
OTHER ITEMS		
Blower Motors (Use Grainger #)	Dayton 4C831	
Wheel Motor, 115V w/4mfd capacitor Use B&W (HI) CW (Y to Y & P to P)	Fasco #D1089	Fasco #D1089

Minimum Replacement Parts Order Amount \$25
 Payment Terms: Visa, Mastercard or Prepay. For UPS COD add \$8.50

Place Orders using Airxchange Part Numbers

